

TSFB45

FÊMEA GIRATÓRIA CURVA 45° BSP

SEDE 60°/BS 5200

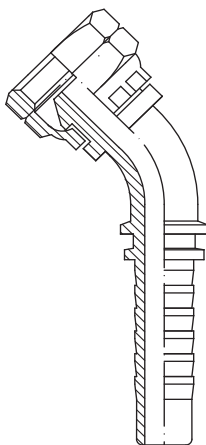

CÓDIGO	ROSCA	MANGUEIRA		
		DN	TRAÇO	POL.
TSFB45-02-04	1/8"X28	06	04	1/4"
TSFB45-04-04	1/4"X19	06	04	1/4"
TSFB45-06-04	3/8"X19	06	04	1/4"
TSFB45-06-06	3/8"X19	10	06	3/8"
TSFB45-08-06	1/2"X14	10	06	3/8"
TSFB45-08-08	1/2"X14	12	08	1/2"
TSFB45-10-08	5/8"X14	12	08	1/2"
TSFB45-10-10	5/8"X14	16	10	5/8"
TSFB45-12-08	3/4"X14	12	08	1/2"
TSFB45-12-10	3/4"X14	16	10	5/8"
TSFB45-12-12	3/4"X14	20	12	3/4"
TSFB45-16-12	1"X11	20	12	3/4"
TSFB45-16-16	1"X11	25	16	1"
TSFB45-20-16	1.1/4"X11	25	16	1"
TSFB45-20-20	1.1/4"X11	32	20	1.1/4"
TSFB45-24-24	1.1/2"X11	40	24	1.1/2"
TSFB45-32-32	2"X11	50	32	2"

TSFB90

FÊMEA GIRATÓRIA CURVA 90° BSP

SEDE 60°/BS 5200

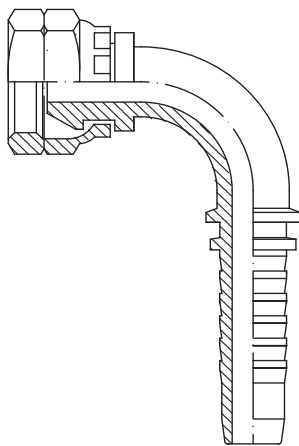

CÓDIGO	ROSCA	MANGUEIRA		
		DN	TRAÇO	POL.
TSFB90-02-04	1/8"X28	06	04	1/4"
TSFB90-04-04	1/4"X19	06	04	1/4"
TSFB90-04-06	1/4"X19	10	06	3/8"
TSFB90-06-04	3/8"X19	06	04	1/4"
TSFB90-06-06	3/8"X19	10	06	3/8"
TSFB90-08-06	1/2"X14	10	06	3/8"
TSFB90-08-08	1/2"X14	12	08	1/2"
TSFB90-08-10	1/2"X14	16	10	5/8"
TSFB90-10-08	5/8"X14	12	08	1/2"
TSFB90-10-10	5/8"X14	16	10	5/8"
TSFB90-12-08	3/4"X14	12	08	1/2"
TSFB90-12-10	3/4"X14	16	10	5/8"
TSFB90-12-12	3/4"X14	20	12	3/4"
TSFB90-16-12	1"X11	20	12	3/4"
TSFB90-16-16	1"X11	25	16	1"
TSFB90-20-16	1.1/4"X11	25	16	1"
TSFB90-20-20	1.1/4"X11	32	20	1.1/4"
TSFB90-24-20	1.1/2"X11	32	20	1.1/4"
TSFB90-24-24	1.1/2"X11	40	24	1.1/2"
TSFB90-32-32	2"X11	50	32	2"

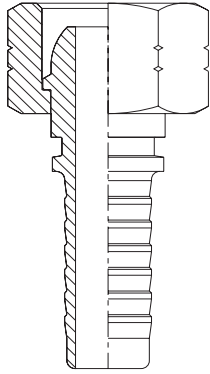
TSFBM**FÊMEA GIRATÓRIA RETA
MÉTRICA BOLEADA - SEDE UNIVERSAL**

CÓDIGO	ROSCA	DN	MANGUEIRA	
			TRAÇO	POL.
TSFBM-08-04	M14X1.5	06	04	1/4"
TSFBM-10-04	M16X1.5	06	04	1/4"
TSFBM-10-06	M16X1.5	10	06	3/8"
TSFBM-12-06	M18X1.5	10	06	3/8"
TSFBM-15-06	M22X1.5	10	06	3/8"
TSFBM-15-08	M22X1.5	12	08	1/2"
TSFBM-18-10	M26X1.5	16	10	5/8"

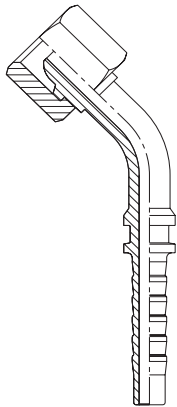
TSFBM45**FÊMEA GIRATÓRIA CURVA 45°
MÉTRICA BOLEADA - SEDE UNIVERSAL**

CÓDIGO	ROSCA	DN	MANGUEIRA	
			TRAÇO	POL.
TSFBM45-08-04	M14X1.5	06	04	1/4"
TSFBM45-10-04	M16X1.5	06	04	1/4"
TSFBM45-10-06	M16X1.5	10	06	3/8"
TSFBM45-12-06	M18X1.5	10	06	3/8"
TSFBM45-15-06	M22X1.5	10	06	3/8"
TSFBM45-15-08	M22X1.5	12	08	1/2"
TSFBM45-18-10	M26X1.5	16	10	5/8"

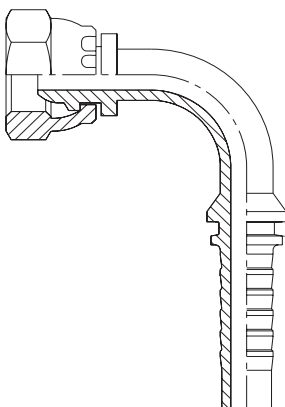
TSFBM90**FÊMEA GIRATÓRIA CURVA 90°
MÉTRICA BOLEADA - SEDE UNIVERSAL**

CÓDIGO	ROSCA	DN	MANGUEIRA	
			TRAÇO	POL.
TSFBM90-08-04	M14X1.5	06	04	1/4"
TSFBM90-10-04	M16X1.5	06	04	1/4"
TSFBM90-10-06	M16X1.5	10	06	3/8"
TSFBM90-12-06	M18X1.5	10	06	3/8"
TSFBM90-15-06	M22X1.5	10	06	3/8"
TSFBM90-15-08	M22X1.5	12	08	1/2"
TSFBM90-18-10	M26X1.5	16	10	5/8"

TSFBJ

FÊMEA GIRATÓRIA RETA BSP/JIC CÔNICO 30°

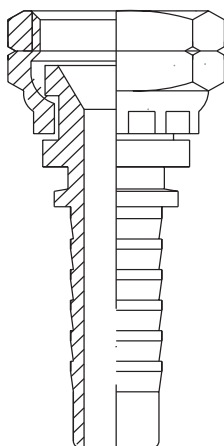

CÓDIGO	ROSCA	MANGUEIRA		
		DN	TRAÇO	POL.
TSFBJ-04-04	1/4"X19	06	04	1/4"
TSFBJ-06-06	3/8"X19	10	06	3/8"
TSFBJ-08-08	1/2"X14	12	08	1/2"
TSFBJ-12-12	3/4"X14	20	12	3/4"
TSFBJ-16-16	1"X11	25	16	1"

TCFB90

FÊMEA GIRATÓRIA COMPACTA BSP CÔNICO 60°

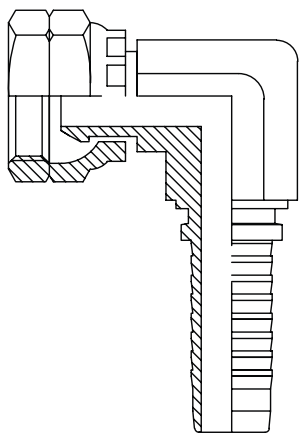

CÓDIGO	ROSCA	MANGUEIRA		
		DN	TRAÇO	POL.
TCFB90-04-04	1/4"X19	06	04	1/4"
TCFB90-06-06	3/8"X19	10	06	3/8"
TCFB90-08-08	1/2"X14	12	08	1/2"
TCFB90-10-10	5/8"X14	16	10	5/8"
TCFB90-12-12	3/4"X14	20	12	3/4"
TCFB90-16-16	1"X11	25	16	1"